

CONTRACTORS SHALL VERIFY JOB DIMENSIONS BEFORE ANY JOB COMMENCES. ALL SHOP DRAWINGS SHALL BE SUBMITTED TO THE SUPERINTENDENT AND MANUFACTURER SHALL NOT COMMENCE FROM THE RETURN OF DRAWINGS SHOWN. BY THE CONSULTANT. DIMENSIONS SHALL TAKE PRECEDENCE OVER SCALE. THIS DRAWING SHALL BE READ IN CONJUNCTION WITH ALL RELEVANT CONTRACT SPECIFICATIONS AND DRAWINGS COPYRIGHT OF THIS DRAWING IS VESTED IN WARDLE.

General Notes

- Rw 35 AWT-01 AWT-02
  - Rw 40 AWT-03
  - Rw 45 AWT-04
  - Rw 50 AWT-05 AWT-06
  - Rw 55 AWT-07 AWT-08
  - Rw 60 AWT-09
- REFER TO AECOM SCHEDULE OF ACOUSTIC PARTITION TYPES

Acoustic Transfers - Refer to AR610 & AR611 for Acoustic Transfer Bulkhead / Duct Locations  
 - Refer to AECOM U.L.A. Mechanical Engineer Specification & Drawings for Requirements

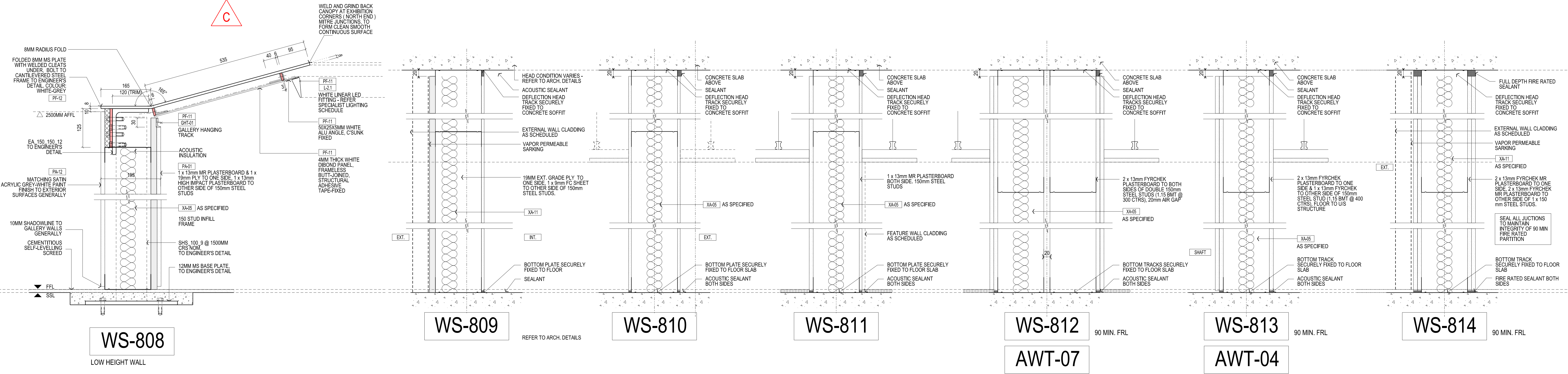
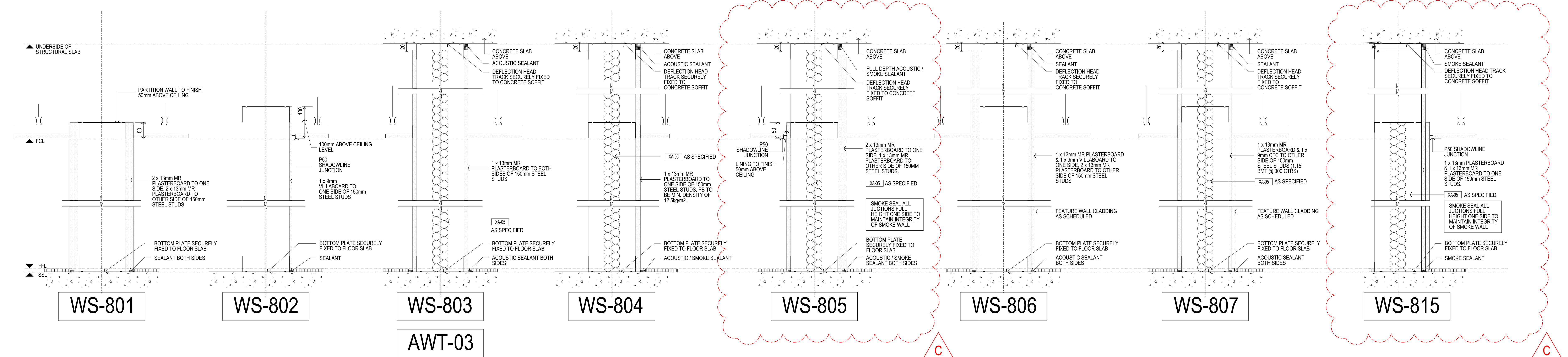
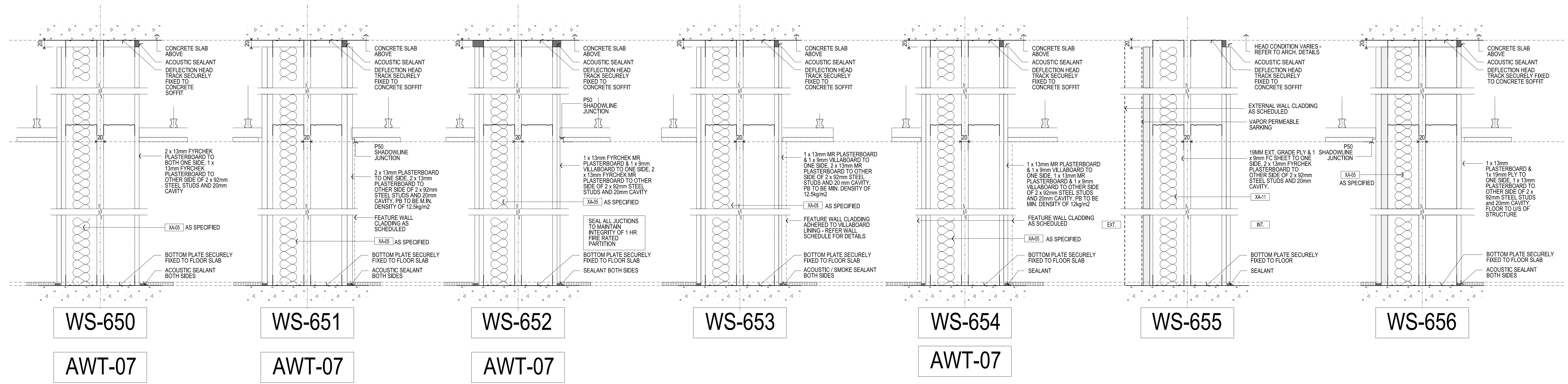

Rev	Issue	Revision Description	And	Date
C	SG	UPDATES AS CLOUDED - WALL TYPE ADDED	-	20.11.13
B	SG	UPDATES AS CLOUDED	-	17.09.13
A	SG	UPDATES TO INCLUDE ACOUSTIC REVISIONS	-	20.08.13
		WALL TYPES ADDED		
07	SG	VALUE MANAGEMENT UPDATE	-	12.04.13
		WALL TYPE ADDED		
06	SG	100% CD - TENDER ISSUE	-	07.09.12
05	SG	90% CD ISSUE	-	10.09.12
04	SG	75% CD ISSUE	-	13.07.12
03	SG	50% CD ISSUE	-	01.06.12
		ACOUSTIC INFORMATION ADDED		
		WALL TYPES ADDED		
02	SG	FINAL CD ISSUE	-	24.02.12
01	SG	DD UPDATE	-	27.01.12



**NADAAA**

NADAAA  
 1920 Washington Street No.2  
 Boston Massachusetts 02118 USA

Telephone +1 817 442 8232  
 Facsimile +1 888 442 1417  
 Email nads@nadaaa.com

**John Wardle Architects**

25 Rokeby Street, Collingwood, Victoria 3066 Australia  
 Tel: +61 3 8662 0400 www.johnwardlearchitects.com  
 © 2012 John Wardle Architects ABN 83 006 814 268

Client **University of Melbourne Parkville Campus**

Project **Faculty of Architecture Building and Planning**

Title **WALL TYPE DETAILS SHEET 5**

Project No. **0913** Scale 1:5 @ A0  
 Drawing No. **AR7504** Revision **C**  
 1:10 @ A2

Date Dec 2011 Drawn - Co-Ord - Check -

FILENAME - \$FILES

**FOR CONSTRUCTION**